

Domekt R 190 V

Maximal air flow, m ³ /h	183
Unit weight, kg	42
Supply voltage, V	1~ 230
Maximal operating current, A	HE 3,3
Thermal efficiency of heat recovery, %	83
Reference flow rate, m ³ /s	0,036
Reference pressure difference, Pa	50
SPI, W/(m ³ /h)	0,27
Filters dimensions B×H×L, mm	285×130×46
Electric power input of the fan drive at reference flow rate, W	15
Electric power input of the fan drive at maximum flow rate, W	41
Electric air heater capacity, kW / Δt, °C	0,5 / 10,8
Control panel	C4.1
Maintenance space, mm	300

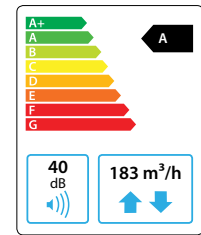

C4.1



Acoustic data

A-weighted sound power level L_{WA} , dB(A) at reference flow rate

Supply inlet	50
Supply outlet	62
Exhaust inlet	50
Exhaust outlet	62
Casing	40

A-weighted sound pressure level L_{pA} , dB(A)

10 m² normally isolated room, distance from casing – 3 m.

Surroundings	30
--------------	----

Temperature efficiency

Outside temperature, °C	Winter					Summer		
	-23	-15	-10	-5	0	25	30	35
After heat exchanger, °C	14,4	15,7	16,6	17,4	18,3	22,5	23,4	24,2

indoor +22°C, 20 % RH

Shown as left (L1)

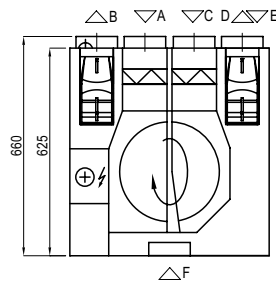

Shown as right (R1)

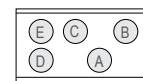

- A outdoor intake
- B supply air
- C extract indoor
- D exhaust air
- E additional extraction connection (by-pass – extraction without heat recovery)
- F kitchen hood connection (by-pass – extraction without heat recovery)

Performance

Unit with standard equipment

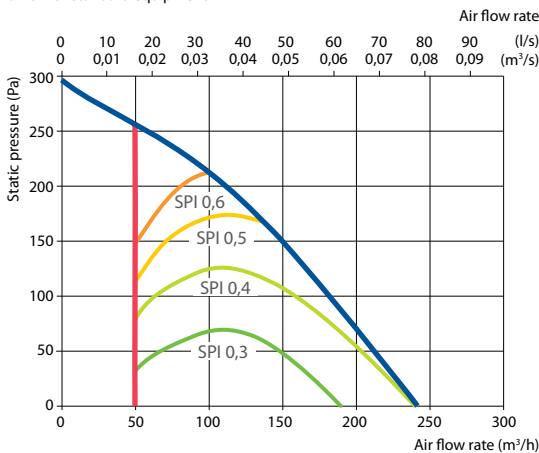

Accessories (p. 123)

Closing damper	AGUJ-M-125+LF230/LM230
	A/D AGS-125-50-600-M
Silencer	B/C AGS-125-50-900-M
Water heater	DH-125
PPU	PPU-HW-3R-15-0,4-W1
2-way valve (water heater)	VVP47.10-0,4

Water cooler	DHCW-125
2-way valve (water cooler)	VVP47.10-1,6
Kitchen hood	KH
Decorative panel	DP
Air distribution box	OSD-200 VE-125
Outdoor grill	LD-125